

# Studiu de insorire - Solstitiu de iarna - 21 decembrie

jud. Arad, str.Obedenaru nr.7

Rasarit 8:08 Apus 16:38

Ora 8:08

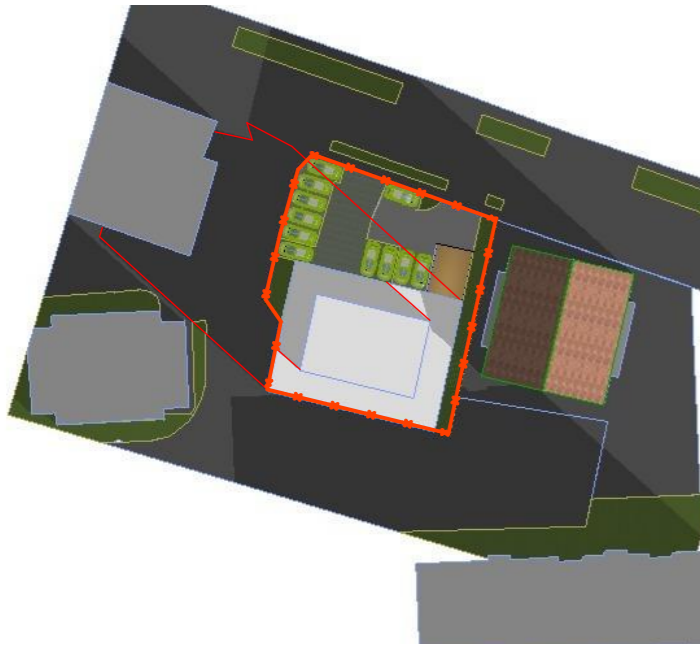

Ora 9:38

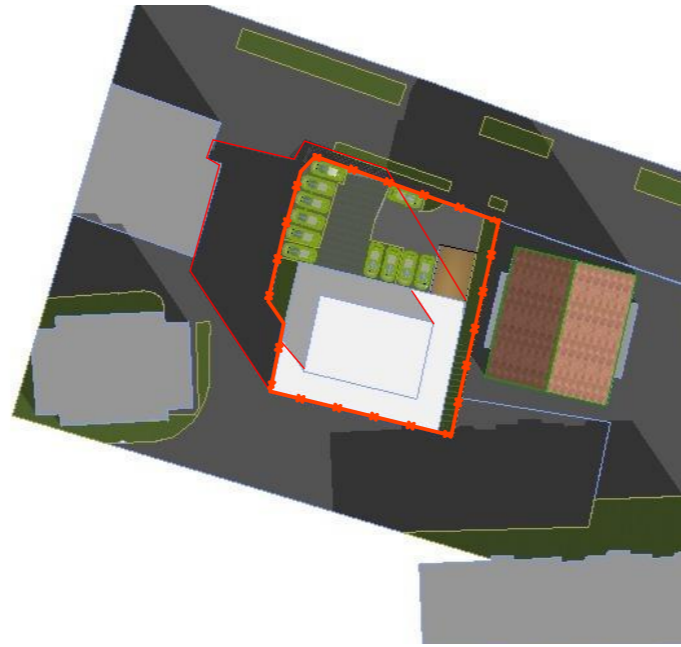

Ora 11:08

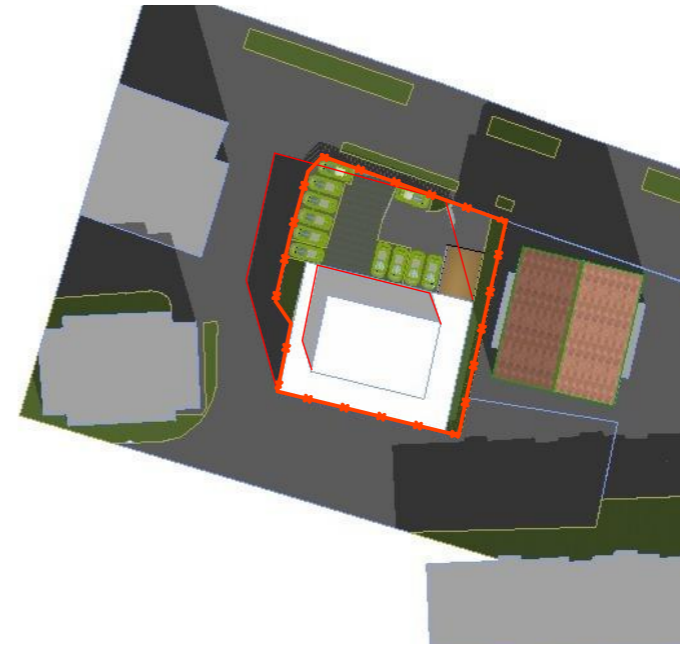

Ora 12:08

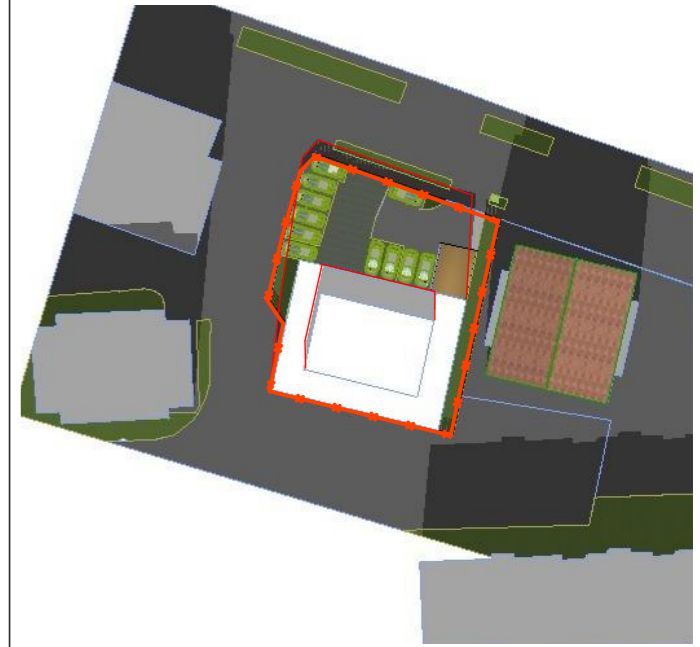

Ora 13:08

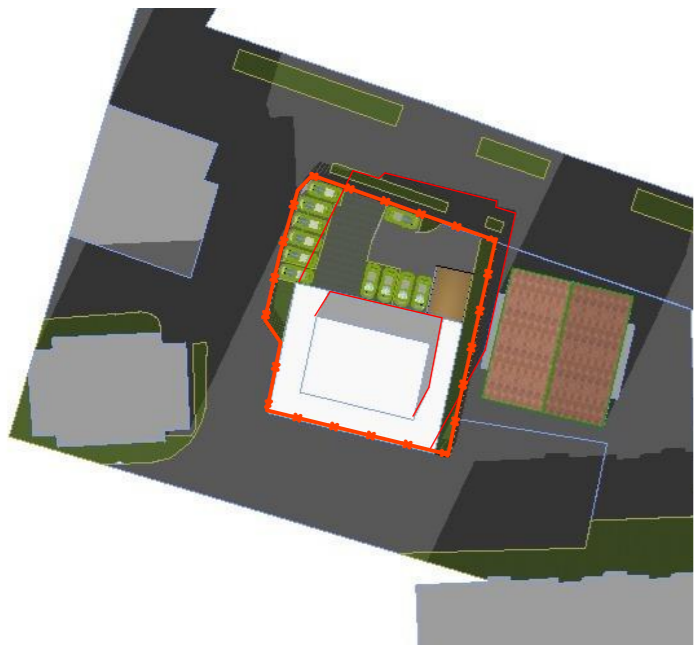

Ora 14:08

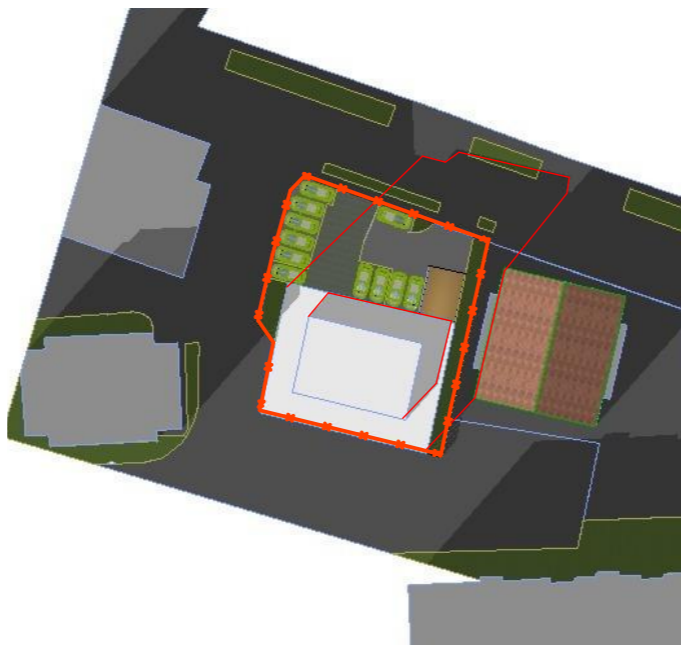

Ora 15:08

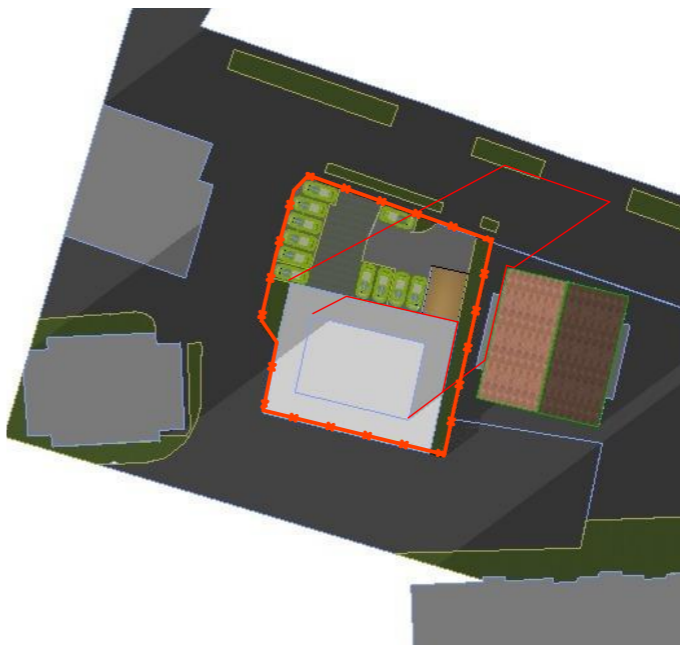

Ora 16:38

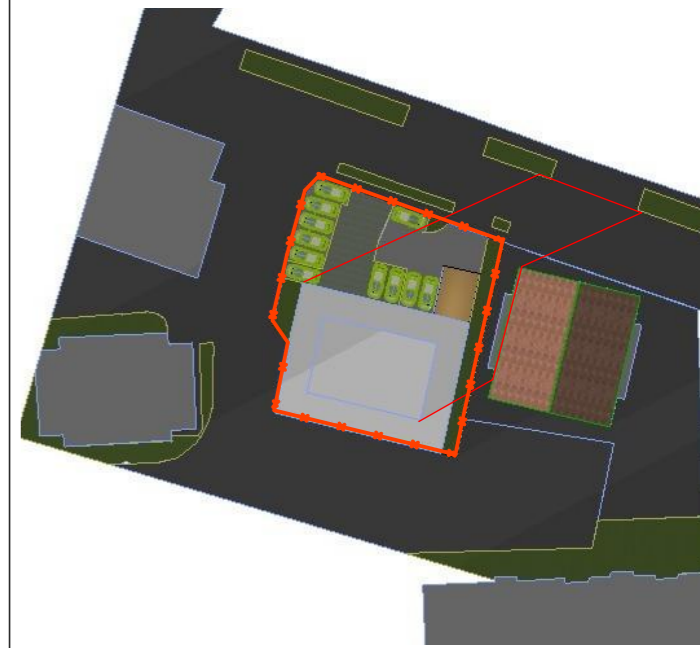

Abaca helioluxmetrica

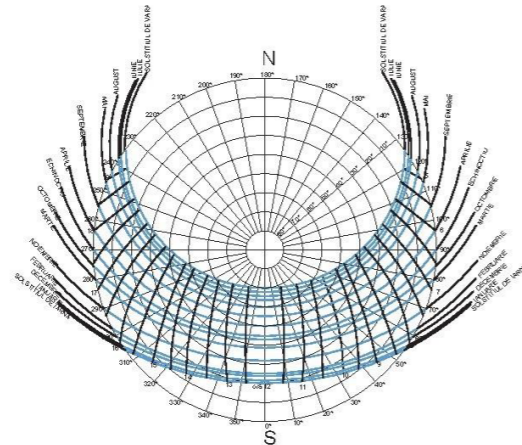

### Legenda:

— umbra cladire propusa

| CALITATE  | NUME             | SEMANTURA | CERINTA          | REFERAT / EXPERTIZA NR.  | DATA  |
|---|------------------|-----------|------------------|--|---|
| EXPERT  |                  |           |                  |  |   |
| VERIFICATOR   |                  |           |                  |  |   |
|  <b>ZUBCU</b><br>proiectare & consultanta<br>ULTRARCH LTD S.R.L.<br>str.Crisan, nr. 9 Sighisoara, Jud.Mures<br>tel: +4 0749 322 701<br>mihazubcu@gmail.com<br>www.zubcu.ro |                  |           |                  | Beneficiar: <b>SABAU VIRGIL ; SABAU EMIL - VASILE</b>                  | Nr. proiect:<br>05/2026   |
|   |                  |           |                  | Titlu proiect:<br>Elaborare PUZ si RLU 'Construire locuinte colective' | Faza:<br>S.O.   |
| SPECIFICATIE  | NUME             | SEMANTURA | Scara:<br>1:1000 | Format:<br>A3  | Jud.Arad, Mun.Arad, Str.Obedenaru, nr.7, CF 341070 Arad si CF 304071 Arad |
| SEF PROIECT   | arh. Zubcu Mihai |           | Data:            |  | Titlu plansa:<br><b>STUDIU DE INSORIRE</b>                                |
| PROIECTAT   | arh. Zubcu Mihai |           | junie 2026       |  | Plansa nr.:<br>05 URB   |
| DESENAT   | arh. Zubcu Mihai |           |                  |  |   |